

Mounted points

Find (1/1)

A200001632616

Previous

Next



Shape ZY, Cylinder, Type 1 (according to DIN 69170)



★★☆

Grinding: Polishing (bonded)

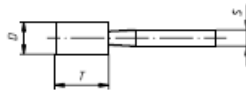

Ordering example: A200000104302

Further dimensions, qualities and shank lengths on request.



PG 3

Product number	Description	Quality	D mm	T mm	S mm	recommended for Information on page 438					
A200001320616	ZY 1320.06	MK 46 N V10	13	20	6 x 40	② ④ ⑤					■ 20
A200001320627	ZY 1320.06	NK 46 OU BA hard	13	20	6 x 40	② ③ ⑤					■ 20
A200001325602	ZY 1325.06	EKR 46 N V4	13	25	6 x 40	① ② ③					■ 20
A200001325647	ZY 1325.06	RKD 60 OU V21	13	25	6 x 40	② ③ ④					■ 20
A200001332602	ZY 1332.06	EKR 46 N V4	13	32	6 x 40	① ② ③					■ 20
A200001332627	ZY 1332.06	NK 46 OU BA hard	13	32	6 x 40	② ③ ⑤					■ 20
A200001332627W	ZY 1332.06	NK 24 NA soft	13	32	6 x 40	② ③ ④ ⑤					■ 20
A200001616802	ZY 1616.06	EKR 46 N V4	16	16	6 x 40	① ② ③					■ 20
A200001616847	ZY 1616.06	RKD 36 O (8) V21	16	16	6 x 40	② ③ ④					■ 20
A200001620602	ZY 1620.06	EKR 46 N V4	16	20	6 x 40	① ② ③					■ 20
A200001620612	ZY 1620.06	EKWBR 46 O/P V7	16	20	6 x 40	① ②					■ 20
A200001620627	ZY 1620.06	NK 24 OU BA hard	16	20	6 x 40	② ③ ⑤					■ 20
A200001632602	ZY 1632.06	EKR 46 N V4	16	32	6 x 40	① ② ③					■ 20
A200001632612	ZY 1632.06	EKWBR 46 O/P V7	16	32	6 x 40	① ②					■ 20
A200001632616	ZY 1632.06	MK 36 N V10	16	32	6 x 40	② ④ ⑤					■ 20
A200001632627	ZY 1632.06	NK 24 OU BA hard	16	32	6 x 40	② ③ ⑤					■ 20
A200001632627W	ZY 1632.06	NK 24 NA soft	16	32	6 x 40	② ③ ④ ⑤					■ 20
A200001632633	ZY 1632.06	HK 30 N V13	16	32	6 x 40	④ ⑤					■ 20
A200001632647	ZY 1632.06	RKD 36 O (8) V21	16	32	6 x 40	② ③ ④					■ 20
A200001640602	ZY 1640.06	EKR 46 N V4	16	40	6 x 40	① ② ③					■ 20
A200001640616	ZY 1640.06	MK 36 N V10	16	40	6 x 40	② ④ ⑤					■ 20
A200001640627	ZY 1640.06	NK 24 OU BA hard	16	40	6 x 40	② ③ ⑤					■ 20
A200002013602	ZY 2013.06	EKR 36 N V4	20	13	6 x 40	① ② ③					■ 20
A200002020602	ZY 2020.06	EKR 36 N V4	20	20	6 x 40	① ② ③					■ 20
A200002020608	ZY 2020.06	EKW 60 L V1	20	20	6 x 40	③		⑦	⑧		■ 20
A200002020616	ZY 2020.06	MK 36 N V10	20	20	6 x 40	② ④ ⑤					■ 20
A200002020627	ZY 2020.06	NK 24 OU BA hard	20	20	6 x 40	② ③ ⑤					■ 20
A200002020647	ZY 2020.06	RKD 36 O (8) V21	20	20	6 x 40	② ③ ④					■ 20
A200002025602	ZY 2025.06	EKR 36 N V4	20	25	6 x 40	① ② ③					■ 20
A200002025647	ZY 2025.06	RKD 36 O (8) V21	20	25	6 x 40	② ③ ④					■ 20
A202202025626	ZY 2025.06	HOK 0-3 V9	20	25	6 x 40				⑥		■ 20
A200002032602	ZY 2032.06	EKR 36 N V4	20	32	6 x 40	① ② ③					■ 20
A2000020326020001	ZY 2032.06	EKR 30/36 OU (7) V21	20	32	6 x 40	① ② ③					■ 20
A200002032616	ZY 2032.06	MK 36 N V10	20	32	6 x 40	② ④ ⑤					■ 20
A200002032627	ZY 2032.06	NK 24 OU BA hard	20	32	6 x 40	② ③ ⑤					■ 20
A200002032633	ZY 2032.06	HK 30 N V13	20	32	6 x 40	④ ⑤					■ 20
A200002032647	ZY 2032.06	RKD 36 O (8) V21	20	32	6 x 40	② ③ ④					■ 20