

HAF

Helmet Air Filter for 1-6 users



AIRBLAST



Airblast Helmet Air Filter (HAF) is designed to remove oil mist, water vapour and particulates down to 0.5 micron from breathing grade compressed air. The Airblast Helmet Air Filter meets OSHA regulation 1910.94 (6) (ii), requiring a trap and carbon filter be installed and regularly maintained to remove objectionable odours, as well as water, oil mist and other particulates.

The Airblast HAF is supplied incl. pressure reducing valve to reduce the pressure to the requirements of supplied air respirators, providing that the inlet pressure does not exceed 8,6 bar (125 PSI).

Operation

The HAF is placed in the breathing-air line between the breathing air source and the respirator supply hose. The HAF is the point of attachment for the respirator hose. Air enters the filter through one of the inlet ports. Moisture is removed by expansion in the outer chamber and is drained through a petcock at the bottom of the unit. The air passes through a replaceable filter cartridge. The outlet pressure is controlled by a regulator on the cap and is measured by a gauge downstream from the cartridge.

Advantages

- One filter suitable for multiple respirators, up to 6 users
- Polypropylene filter cartridge casing eliminates corrosion hazard
- Filter cartridge lasts up to 3 months (based on 40 hours week)
- Filters can be floor or wall mounted

HAF assembly

Part no.	Description
4300000	HAF-I Helmet Air Filter for 1-2 users
4320000	HAF-II Helmet Air Filter for 1-6 users

HAF Parts List

Item	Part no.	Description
01	4301000	3/8" Tee - brass
02	4302000	3/8" Pressure regulator
03	4303000	Pressure gauge
04	4304000	3/8" Pressure regulator – high flow (optional)
05	4305000	Pressure gauge – high flow (optional)
06	4306000	Pressure relief valve
07	4307000	Filter cover for 1 or 2 users HAF
08	4308000	Filter cover for 1-6 users HAF (optional)
09	4309000	Outlet manifold for 1-6 users (optional)
10	4310000	Filter housing
11	4311000	O-ring (set of 2)
12	4312000	Bolt (set of 4)
13	4313000	Base / Wall mount
14	2175200	CCC-38/I Quick coupling 1 or 2 users
15	2174200	CCC-38/O Quick coupling for 1-6 users
16	2225500	Hex nipple 1"
17	4250401	Filter cartridge for HAF
18	2170400	KAG-10 Quick coupling 1"outer thread
19	4316000	Drain valve - brass

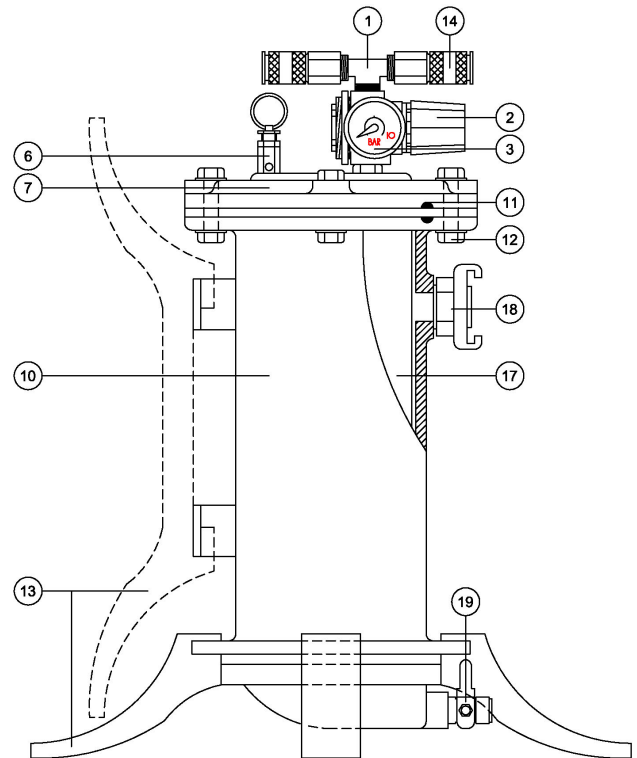

High flow regulator

6-outlet top view

6-outlet side view

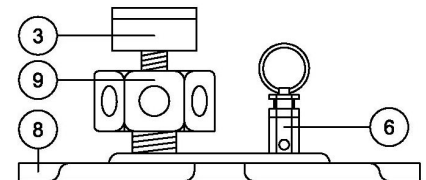
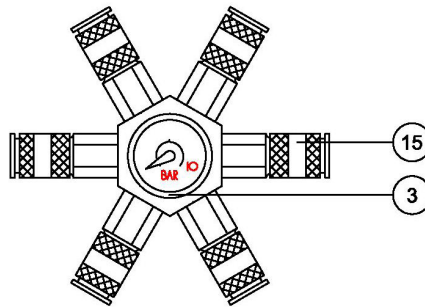
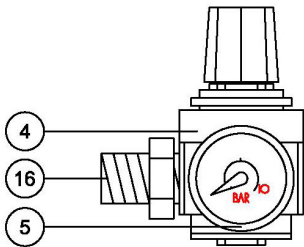

Delivery includes

- HAF Assembly
- Pressure regulator
- Pressure relief valve
- Bracket for stand or wall mount
- Drain valve
- Filter cartridge

Helmet Air Hose - Optional

Part no.	Description
2527000	Helmet Air Hose 3/8" - 9 mm ID (9 x 16), 10 bar working pressure
2527400	Helmet Air Hose 3/8" - 9 mm ID (9 x 16), 10 bar working pressure, coupled 5 meters
2527500	Helmet Air Hose 3/8" - 9 mm ID (9 x 16), 10 bar working pressure, coupled 20 meters
2527700	Helmet Air Hose 3/8" - 9 mm ID (9 x 16), 10 bar working pressure, coupled 40 meters