



Find (1/2)

A200001020602

Previous

Next

Mounted points

Shape ZY, Cylinder, Type 1 (according to DIN 69170)



★★☆

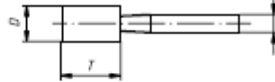

Ordering example: A200000104302

Further dimensions, qualities and shank lengths on request.



Grinding, Polishing (Banded)



PG 3

Product number	Description	Quality	D mm	T mm	S mm	recommended for information on page 43B		
A200000810608	ZY 0810.06	EKW 80 LV1	8	10	6 x 40		⑦	⑩
A200000810647	ZY 0810.06	RKD 80 QU V21	8	10	6 x 40	② ③ ④		
A200000816302	ZY 0816.03	EKR 60 N V4	8	16	3 x 30	① ② ③		
A200000816312	ZY 0816.03	EKWBR 60 O/P V7	8	16	3 x 30	① ②		
A200000816347	ZY 0816.03	RKD 80 QU V21	8	16	3 x 30	② ③ ④		
A200000818602	ZY 0816.06	EKR 60 N V4	8	16	6 x 40	① ② ③		
A200000818647	ZY 0816.06	RKD 80 QU V21	8	16	6 x 40	② ③ ④		
A200000820602	ZY 0820.06	EKR 60 N V4	8	20	6 x 40	① ② ③		
A200001010302	ZY 1010.03	EKR 60 N V4	10	10	3 x 30	① ② ③		
A2000010103020001	ZY 1010.03	EKR 60/80 QU V4	10	10	3 x 30	① ② ③		
A200001010312	ZY 1010.03	EKWBR 60 O/P V7	10	10	3 x 30	① ②		
A200001010347	ZY 1010.03	RKD 80 P V21	10	10	3 x 30	② ③ ④		
A200001010602	ZY 1010.06	EKR 60 N V4	10	10	6 x 40	① ② ③		
A200001010608	ZY 1010.06	EKW 60 LV1	10	10	6 x 40	③	⑦	⑩
A200001010647	ZY 1010.06	RKD 80 P V21	10	10	6 x 40	② ③ ④		
A200001013302	ZY 1013.03	EKR 60 N V4	10	13	3 x 30	① ② ③		
A200001013312	ZY 1013.03	EKWBR 60 O/P V7	10	13	3 x 30	① ②		
A200001013602	ZY 1013.06	EKR 60 N V4	10	13	6 x 40	① ② ③		
A200001020602	ZY 1020.06	EKR 60 N V4	10	20	6 x 40	① ② ③		
A2000010206020001	ZY 1020.06	EKR 46 QU V4	10	20	6 x 40	① ② ③		
A200001020612	ZY 1020.06	EKWBR 60 O/P V7	10	20	6 x 40	① ②		
A200001020616	ZY 1020.06	MK 46 N V10	10	20	6 x 40	②	④ ⑤	
A200001020627	ZY 1020.06	NK 46 QU BA hard	10	20	6 x 40	② ③ ④	⑤	
A200001032602	ZY 1032.06	EKR 60 N V4	10	32	6 x 40	① ② ③		
A2000010326020001	ZY 1032.06	EKR 46 QU V4	10	32	6 x 40	① ② ③		
A200001032612	ZY 1032.06	EKWBR 60 O/P V7	10	32	6 x 40	① ②		
A200001032627	ZY 1032.06	NK 46 QU BA hard	10	32	6 x 40	② ③ ④	⑤	
A200001040602	ZY 1040.06	EKR 60 N V4	10	40	6 x 40	① ② ③		
A200001040627	ZY 1040.06	NK 46 QU BA hard	10	40	6 x 40	② ③ ④	⑤	
A200001313302	ZY 1313.03	EKR 46 N V4	13	13	3 x 30	① ② ③		
A200001313312	ZY 1313.03	EKWBR 60 O/P V7	13	13	3 x 30	① ②		
A200001313347	ZY 1313.03	RKD 60 P (B) V21	13	13	3 x 30	② ③ ④		
A200001313602	ZY 1313.06	EKR 46 N V4	13	13	6 x 40	① ② ③		
A200001313647	ZY 1313.06	RKD 60 P (B) V21	13	13	6 x 40	② ③ ④		
A200001320602	ZY 1320.06	EKR 46 N V4	13	20	6 x 40	① ② ③		
A2000013206020001	ZY 1320.06	EKR 46 QU V4	13	20	6 x 40	① ② ③		
A200001320612								

Inox/Steel

