

Shape ZY, Cylinder, Type 1 (according to DIN 69170)

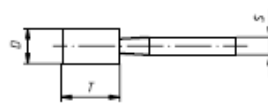

Ordering example: A200000104302

Further dimensions, qualities and shank lengths on request.



Grinding, Polishing (bonded)

Product number	Description	Quality	D mm	T mm	S mm	recommended for information on page 438	PG 3	
A200002040602	ZY 2040.06	EKR 36 N V4	20	40	6 x 40	① ② ③		20
A200002040612	ZY 2040.06	EKWBR 46 O/P V7	20	40	6 x 40	① ②		20
A200002040616	ZY 2040.06	MK 36 N V10	20	40	6 x 40	② ④ ⑤		20
A200002040627	ZY 2040.06	NK 24 OU BA hard	20	40	6 x 40	② ③ ⑤		20
A200002040627W	ZY 2040.06	NK 24 N BA soft	20	40	6 x 40	② ③ ④ ⑤ ⑥		20
A200002040633	ZY 2040.06	HK 30 N V13	20	40	6 x 40	② ④ ⑤		20
A200002040647	ZY 2040.06	RKD 36 O (8) V21	20	40	6 x 40	② ③ ④		20
A200002040827	ZY 2040.08	NK 24 OU BA hard	20	40	8 x 40	② ③ ⑤		20
A200002040827W	ZY 2040.08	NK 24 N BA soft	20	40	8 x 40	② ③ ④ ⑤ ⑥		20
A200002040833	ZY 2040.08	HK 30 N V13	20	40	8 x 40	② ④ ⑤		20
A200002520602	ZY 2520.06	EKR 36 N V4	25	20	6 x 40	① ② ③ ⑤		20
A200002525602	ZY 2525.06	EKR 36 N V4	25	25	6 x 40	① ② ③		20
A200002525627	ZY 2525.06	NK 24 OU BA hard	25	25	6 x 40	② ③ ⑤		20
A200002525647	ZY 2525.06	RKD 30 O (8) V21	25	25	6 x 40	② ③ ④		20
A200002532602	ZY 2532.06	EKR 36 N V4	25	32	6 x 40	① ② ③ ⑤		20
A200002532616	ZY 2532.06	MK 36 N V10	25	32	6 x 40	② ④ ⑤		20
A200002532627	ZY 2532.06	NK 24 OU BA hard	25	32	6 x 40	② ③ ⑤		20
A200002532627W	ZY 2532.06	NK 24 N BA soft	25	32	6 x 40	② ③ ④ ⑤ ⑥		20
A200002532633	ZY 2532.06	HK 30 N V13	25	32	6 x 40	② ④ ⑤		20
A200002532647	ZY 2532.06	RKD 30 O (8) V21	25	32	6 x 40	② ③ ④		20
A200003220602	ZY 3220.06	EKR 30 N V4	32	20	6 x 40	① ② ③ ⑤		20
A200003220616	ZY 3220.06	MK 36 N V10	32	20	6 x 40	② ④ ⑤		20
A200003220627	ZY 3220.06	NK 24 OU BA hard	32	20	6 x 40	② ③ ⑤		20
A200003232602	ZY 3232.06	EKR 30 N V4	32	32	6 x 40	① ② ③ ⑤		20
A2000032326020001	ZY 3232.06	EKR 30/36 OU (7) V21	32	32	6 x 40	① ② ③		20
A200003232612	ZY 3232.06	EKWBR 46 O/P V7	32	32	6 x 40	① ②		20
A200003232616	ZY 3232.06	MK 36 N V10	32	32	6 x 40	② ④ ⑤		20
A200003232627	ZY 3232.06	NK 24 OU BA hard	32	32	6 x 40	② ③ ⑤		20
A200003232627W	ZY 3232.06	NK 24 N BA soft	32	32	6 x 40	② ③ ④ ⑤ ⑥		20
A200003232647	ZY 3232.06	RKD 30 O (8) V21	32	32	6 x 40	② ③ ④		20
A200003240602	ZY 3240.06	EKR 30 N V4	32	40	6 x 40	① ② ③ ⑤		20
A200003240616	ZY 3240.06	MK 36 N V10	32	40	6 x 40	② ④ ⑤		20
A200003240647	ZY 3240.06	RKD 30 O (8) V21	32	40	6 x 40	② ③ ④		20
A200003250827	ZY 3250.08	NK 24 O BA 64	32	50	8 x 40	② ③ ⑤		20
A200004020602	ZY 4020.06	EKR 30 N V4	40	20	6 x 40	① ② ③ ⑤		20
A200004020616	ZY 4020.06	MK 36 N V10	40	20	6 x 40	② ④ ⑤		20
A200004020627	ZY 4020.06	NK 24 OU BA hard	40	20	6 x 40	② ③ ⑤		20

Inox/Steel

