

Mounted points

Find (1/1) ✕

A201903838626 ⚙️

Previous Next



Shape KU, Spherical (according to DIN 69170)



Grinding, Polishing (bonded)

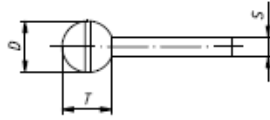

Ordering example: A201100606302

Further dimensions, qualities and shank lengths on request.



PG 3

Product number	Description	Quality	D mm	T mm	S mm	recommended for Information on page 438			
A201100606302	KU 0606.03	EKR 60 N V4	6	6	3 x 30	① ② ③			■ 20
A2011006063020001	KU 0606.03	EKR 80/100 QU V4	6	6	3 x 30	① ② ③			■ 20
A201100606312	KU 0606.03	EKWBR 60 Q/P V7	6	6	3 x 30	① ②			■ 20
A201100606602	KU 0606.06	EKR 60 N V4	6	6	6 x 40	① ② ③			■ 20
A201100606612	KU 0606.06	EKWBR 60 Q/P V7	6	6	6 x 40	① ②			■ 20
A201100808302	KU 0808.03	EKR 60 N V4	8	8	3 x 30	① ② ③			■ 20
A201100808312	KU 0808.03	EKWBR 60 Q/P V7	8	8	3 x 30	① ②			■ 20
A201100808602	KU 0808.06	EKR 60 N V4	8	8	6 x 40	① ② ③			■ 20
A2011008086020001	KU 0808.06	EKR 60/80 QU V4	8	8	6 x 40	① ② ③			■ 20
A201101010302	KU 1010.03	EKR 60 N V4	10	10	3 x 30	① ② ③			■ 20
A201101010312	KU 1010.03	EKWBR 60 Q/P V7	10	10	3 x 30	① ②			■ 20
A201101010347	KU 1010.03	RKD 80 P V21	10	10	3 x 30	② ③ ④			■ 20
A201101010602	KU 1010.06	EKR 60 N V4	10	10	6 x 40	① ② ③			■ 20
A201101313302	KU 1313.03	EKR 46 N V4	13	13	3 x 30	① ② ③			■ 20
A201101313602	KU 1313.06	EKR 46 N V4	13	13	6 x 40	① ② ③			■ 20
A2011013136020001	KU 1313.06	EKR 46 QU V4	13	13	6 x 40	① ② ③			■ 20
A201101616602	KU 1616.06	EKR 46 N V4	16	16	6 x 40	① ② ③			■ 20
A201101616647	KU 1616.06	RKD 60 P (B) V21	16	16	6 x 40	② ③ ④			■ 20
A201102020602	KU 2020.06	EKR 36 N V4	20	20	6 x 40	① ② ③			■ 20
A2011020206020001	KU 2020.06	EKR 60 P V21	20	20	6 x 40	① ② ③			■ 20
A201102020612	KU 2020.06	EKWBR, 46 Q/P V7	20	20	6 x 40	① ②			■ 20
A201102525602	KU 2525.06	EKR 36 N V4	25	25	6 x 40	① ② ③			■ 20
A201102525627	KU 2525.06	NK 24 N BA soft	25	25	6 x 40	② ③ ④ ⑤	⑥		■ 20
A201102525647	KU 2525.06	RKD 30 QU V21	25	25	6 x 40	② ③ ④			■ 20
A201902525626	KU 2525.06	HOK 0-3 V9	25	25	6 x 40			⑦	■ 20
A201103232602	KU 3232.06	EKR 30 N V4	32	32	6 x 40	① ② ③			■ 20
A201903838626	KU 3838.06	HOK 0-3 V9	38	38	6 x 40			⑧	■ 20